



U.S. REGIONAL SEMI-FINAL TOUR GUIDE

SAN FRANCISCO, CA

February 5-8, 2026

THEATER

Chorus Hall (THURSDAY and FRIDAY Only, February 5-6, 2026)

Website: <https://www.chorushall.com/>

Address: 30 Otis St. San Francisco, CA 94103

Stage Size: 35' X 30'

Auditorium Size: 200 Seats

Nearby restaurants: A variety of options within a 5 minute drive from the theater

Parking: paid garage parking, limited paid street parking nearby

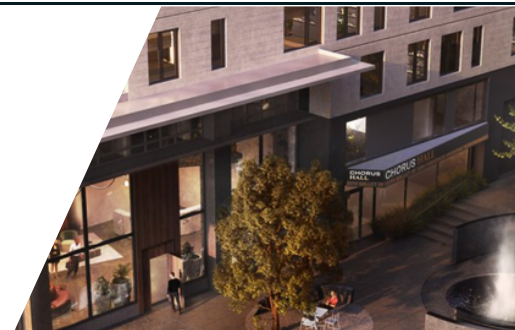

Located in the heart of San Francisco at Otis and 12th Street, Chorus Hall joins the reinvigoration of this historically vibrant and bustling neighborhood. From the street, the Chorus Hall marquee illuminates the block with a digital ticker tape announcing current and upcoming events.

THEATER

Hillsdale Theater (SATURDAY and SUNDAY Only, February 7-8, 2026)

Website: <http://smuhd.theater/hillsdale-theater/>

Address: 3115 Del Monte St, San Mateo, CA 94403

Stage Size: 35' X 30'

Auditorium Size: 764 Seats

Nearby restaurants: A variety of options within a 10 minute drive from the theater

Parking: lot available nearby

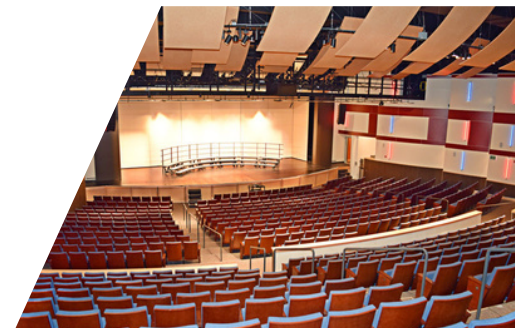

STUDIOS

San Francisco Ballet School

Website: <https://www.sfballet.org/school>

Address: 455 Franklin St., San Francisco, CA 94102

Parking: Several options available: street parking at the meters for approximately \$4/2 hours;
Performing Arts Garage [360 Grove St., San Francisco, CA 94102](#)



DISTANCES

Distance from airport to theater: 11 miles, approximately 19 min drive